



OP-SYSTEM

INSTRUCTION MANUAL

For optimal and safe handling of the product, thoroughly reading and following the present Instruction Manual is essential.

Instruction Manual for OP-SYSTEM

Veterinary Treatment and Surgery Equipment

Item code: 6H2.521 OP-System (moveable) with flat, stationary top

6H2.531 OP-System (moveable) with V-Top

6H2.541 OP-System (moveable) with sliding top

6H2.551 OP-System (moveable) X-Top
with removable laparoscopy cut-outs

H.....height adjustable

5=electric

7=battery

Congratulations on your purchase of the present veterinary treatment and surgery equipment. We are very delighted that you have made the decision to select a *panno-med* product. During the development and manufacturing of our products, we place particular emphasis on safety and ease of use. The high quality standard of *panno-med* products guarantees an extensive product lifespan.

The present device has been developed in close cooperation with leading veterinary surgeons and scientists around the globe and is built according to the highest quality requirements and technical standards. The excellent quality of workmanship guarantees the user a massive competitive advantage into the future.

Hence, in order to make optimal use of the purchased equipment, it is particularly integral to thoroughly and carefully study this Instruction Manual prior to use.

Table of contents

Scope of application	4
Technical specifications	5
Operation and handling	6
Height adjustment	6
Longitudinal adjustment	7
Lateral adjustment	7
Fixation and maneuverability of the table	8
Version with sliding top	8
V-Top adjustment (Version with V-Top)	9
Usage of laparoscopy cut outs (Version with X-Top)	11
Usage of tie-down cleat (accessory part)	14
Usage of drain gutter (accessory for V-Top version)	15
Usage of drip tray (Version with X-Top)	15
Power supply (electric version with power cord)	16
Charging the table (battery-powered version)	16
Error handling & Troubleshooting	19
Cleaning and disinfection instructions	20
Cleaning synthetic top	20
Cleaning stainless steel top (version with V-Top)	21
Supplementary cleaning recommendations for powder-coated surfaces	22
Maintenance & Repair	25
Regular maintenance check	25
Spare parts and accessories	26
Safety responsibility	28
Special warnings	29
Product warranty	30

Scope of application

According to its specifications, options and accessories, the present equipment is intended for exclusive use in veterinary examinations, treatments as well as surgeries within a veterinary clinic, veterinary practice, or other veterinary facilities.

Intended purpose of Instruction Manual

This Instruction Manual is intended to introduce you to the use, maintenance, servicing, and safety of your new, veterinary device. Another purpose of these operating instructions is to provide you with a clear and transparent overview of the functions and technical aspects of the equipment. We strongly recommend that you read this document carefully and follow the recommendations thoroughly in order to use your new device optimally and safely. Hence, *panno-med* cannot be held liable for any damage or injury resulting from improper or incorrect use of the product.

The maintenance and care procedures for the product are designed to ensure that it achieves a long lifespan.

It is therefore essential that all the operating personnel are informed about the proper handling of the product. Thus, the entire operating personnel must have access to this documentation and be informed about the proper handling of the product and the risks associated with its utilization. Furthermore, the product may only be handled by qualified personnel who have been appropriately trained about the risks associated with improper use.

The manufacturer reserves the right to change the information in this document without prior notice, should it appear necessary from our point of view. Any complete or partial disclosure or reproduction of this Instruction Manual is not permitted without the explicit authorization of *panno-med*.

Technical specifications

Table top length:	1390 mm (= 55 inch)
Table top width:	500 mm (= 19.7 inch)
Table top length (V-Top and X-Top):	1430 mm (= 56.3 inch)
Table top width (V-Top and X-Top):	500 mm (= 19.7 inch)
Laparoscopy cut-out size (X-Top):	630 mm long side (= 24.8 inch) 390 mm short side (= 15.4 inch) 120 mm width (= 4.7 inch)
Height adjustment:	from ca. 590 - 990 mm (=23.2 - 39.0 inch)
Height adjustment (V-Top and X-Top):	from ca. 640 - 1040 mm (=25.2 - 40.9 inch)
Maximum load capacity (electric):	120 kg (= 265 lbs) with uniform load distribution
Maximum lateral adjustment:	+/- 40°
Maximum longitudinal adjustment:	+/- 15°
Maximum V-Top adjustment:	ca. 45° per side (V-Top total ca. 90°)
Net weight:	ca. 91 - 96 kg* (= 200 - 212 lbs)
Gross weight incl. packaging:	ca. 127 - 132 kg* (= 280 - 291 lbs)
* Weight depending on width, accessories and other options	
Packaging dimensions:	1480 x 610 x 990 mm (= 58.3 x 24.0 x 39.0 inch)
Voltage (electrical version):	230V~, 50/60Hz, max. 3A (valid for EU, CH, UK, AUS, CN) 120V~, 60Hz, max. 5.8A (USA)
Full load time: 10% (max. 2 min/20 min in operation)	

Electrical data (battery): 24V DC, 2.9Ah

In the scope of delivery for the present product are also included as standard 4 tie-down cleats (item code 602.601).

Operation and handling

The adjustment of the product is usually carried out by a hand control which is normally attached to a side rail and can be removed whenever necessary to enable an easier handling of the table.

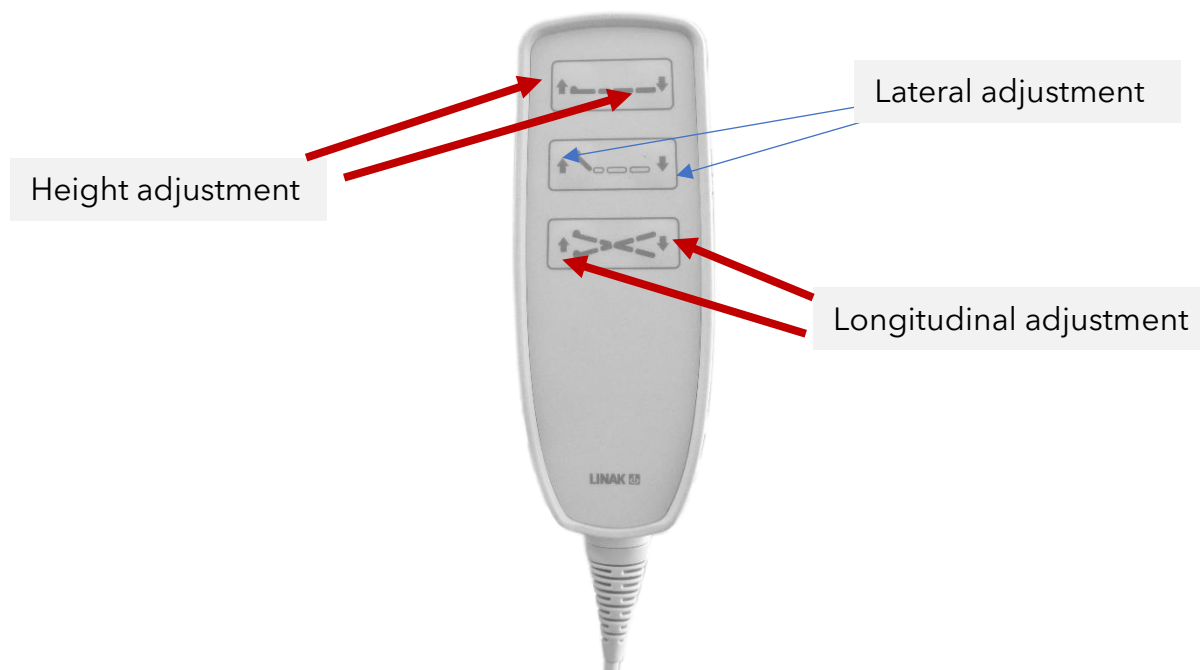

The height adjustment, longitudinal adjustment and lateral adjustment are performed by electronic actuators. By pressing the above-mentioned buttons on the hand control, the height adjustment as well as the longitudinal and lateral adjustment are carried out.

The relevant button must be held down until the desired position of the table is reached and the product is brought to a standstill again.

Height adjustment

The height adjustment of the product is carried out by pressing the two upper buttons on the hand control. If the left button is pressed and held in this context, the table is lifted. Conversely, the product is lowered by pressing and holding the upper right button.

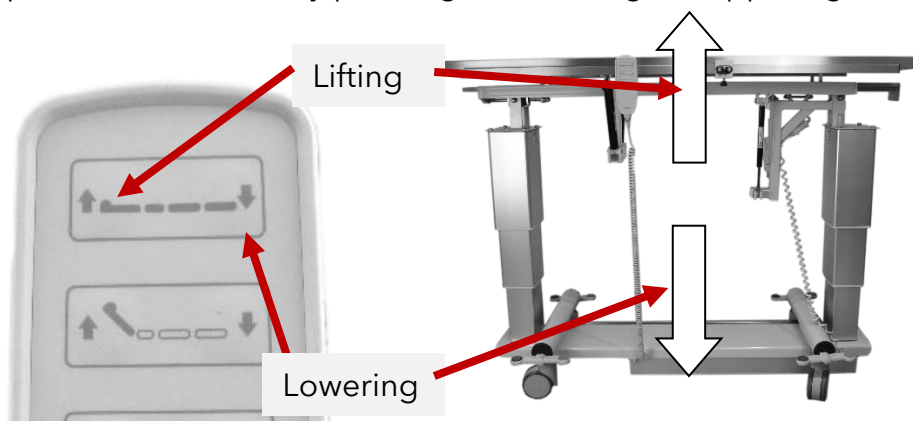

Longitudinal adjustment

Longitudinal adjustment of the product is carried out by actuating the lower buttons on the hand control. When the left button is pressed and held, the table is tilted longitudinally to a positive angle (raised at the front side). Conversely, pressing and holding the lower right button tilts the product longitudinally to a negative angle (lowered at the front side).

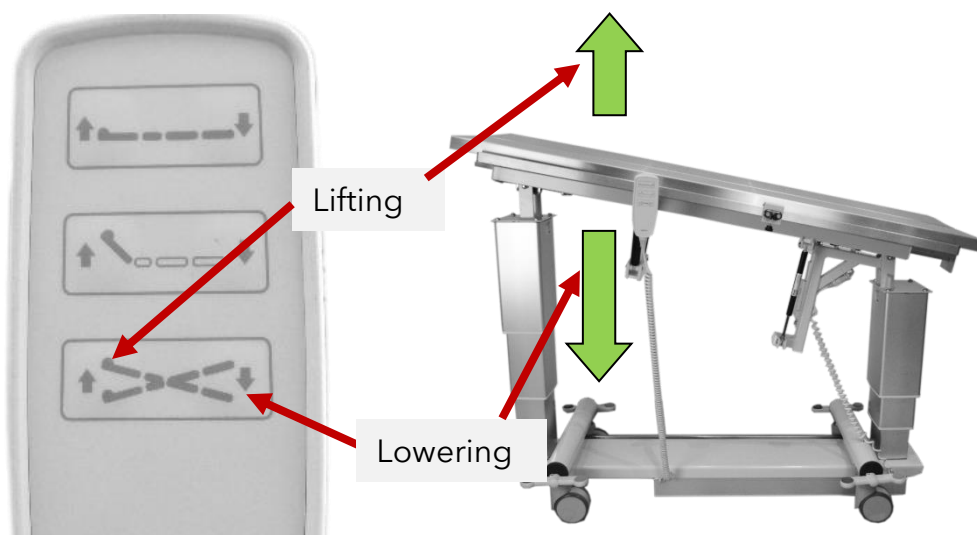

Lateral adjustment

Lateral adjustment of the product is carried out by actuating the two middle buttons on the hand control. Pressing and holding the left, middle button rotates the table laterally in a clockwise direction (raised at the front side). Conversely, pressing and holding the right middle button moves the product longitudinally to a negative angle (lowered at the front side).

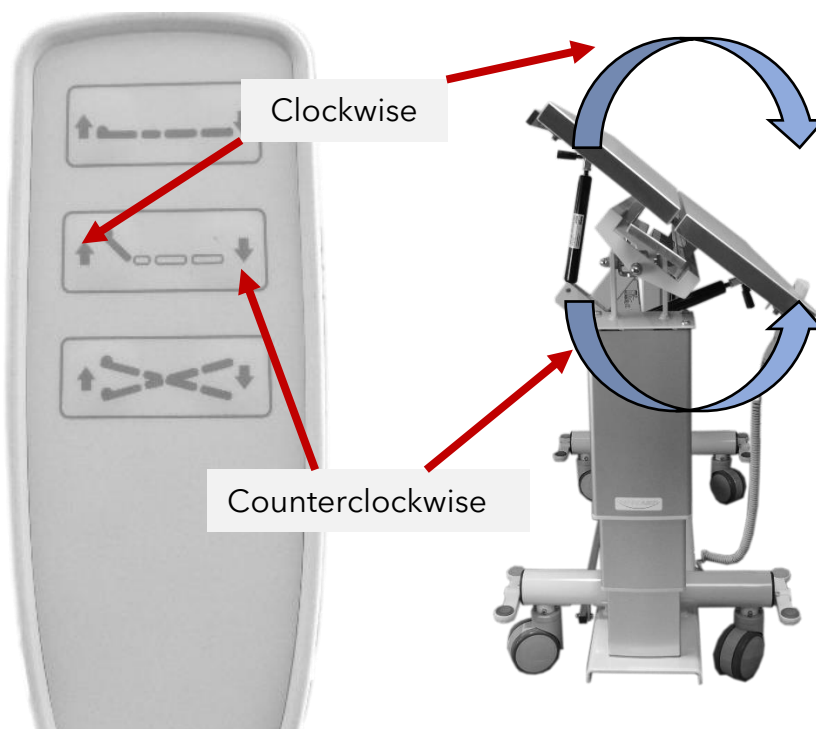

Fixation and maneuverability of the table

The treatment and surgery table OP-System was developed for comfortable use in both seated and standing postures. Having four intercommunicating castors provides safe and stable positioning of the table and at the same time ensures flexible maneuverability.

The product can be centrally locked in the designated position from any given castor by means of pedals. Blocking is achieved by turning the lever on any castor, while simultaneously all other pedals are adjusted equivalently in an automated manner.

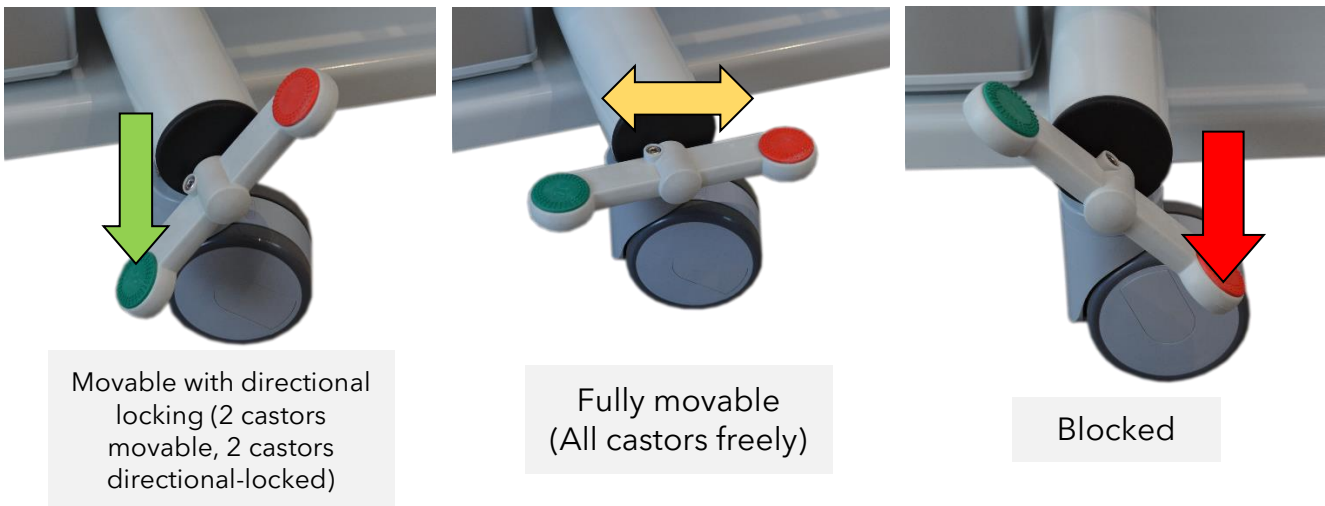

Pressing the pedal down on the green side allows the two adjacent castors to be moved without restriction, while the two opposite castors can only be moved in the direction of travel. When setting the pedal to a horizontal position, all four castors are fully maneuverable and can be moved without restriction. This adjustment is ideal for transportation steering from one axle. Finally, for central blocking and complete locking of the product, the lever (again on any of the castors) can be pressed down on the red side.

Version with sliding top

In case you have chosen an OP-System with the sliding top version, the upper frame connected to the table top can be extended so that the product offers an even larger X-ray area, which is particularly valuable for modern C-arm X-ray applications.

To remove the upper frame, loosen the two screws on the long side of the table underneath the upper frame. (CAUTION: Do not unscrew the screws completely from the threads.) During this process, the two screws must be rotated counterclockwise.

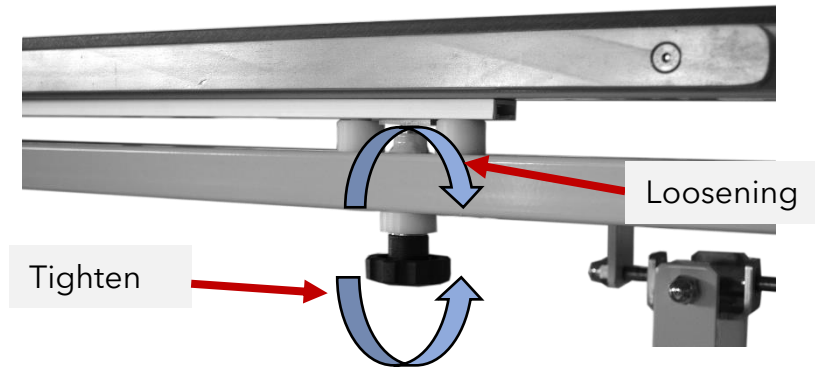

Once the two locking screws have been loosened, the upper frame can be easily pulled out of the structure. Having reached the desired position of the top, the two screws must be tightened again (turned clockwise) to achieve the most stable positioning of the table top.



To retract the upper frame back to its original position within the structure, loosen the two screws as already described above, slide the frame back and tighten the two screws again.

V-Top adjustment (Version with V-Top)

In case your product consists of a stainless steel V-Top, you have the possibility to adjust your table top to a V-shaped position.

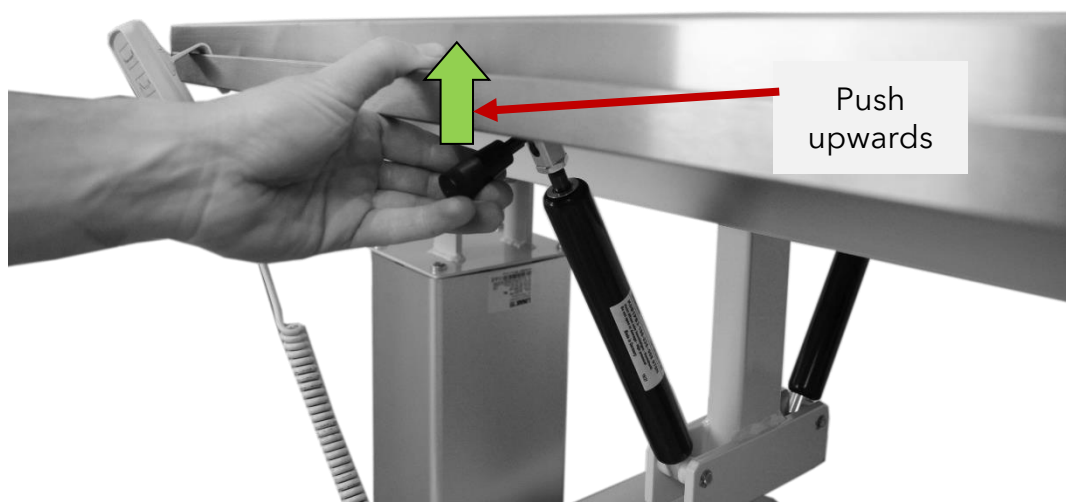

For each half of the table top, the lever on the respective gas pressure spring must be pushed upwards. Hold the lever in position and maneuver the respective table top half until the desired angle of tilt is reached. The gas spring support should enable the upward movement of the table top to be carried out fairly comfortably, while the downward movement requires additional assistance from the user.



Once the desired positioning of the table top has been reached, the lever on the gas pressure spring can be released. The table is now locked in the selected configuration.

If the table top is to be returned to the initial position, the lever on the gas pressure spring must be pushed and held again, the respective half of the tabletop moved downward, and the lever released once the target position has been attained.

Usage of laparoscopy cut outs (Version with X-Top)

In addition to the possibility of V-top adjustment, the OP-System in the X-Top version also features removable and re-installable laparoscopy cut-outs on both sides. These can be removed individually and independently of each other as well as reinserted accordingly.

If the laparoscopy cut-outs are detached, please ensure that they are adequately stored and appropriately protected without being contaminated or damaged until they are reconnected to the table.

ATTENTION: The two removable laparoscopy cut-outs are not identical or interchangeable. When removing and reinserting these laparoscopy cut-outs, they must always be reinstalled on the correct side of the table top (labelled with stickers on which the respective strips/arrows must be joined), as they will otherwise not be aligned properly with the remaining table top or might even cause damage.

To remove a laparoscopy cut-out, first loosen the two locking screws (as shown below) on the side of the upper frame (however, do not loosen them completely to ensure that the corresponding screws remain connected to the table and cannot be lost).

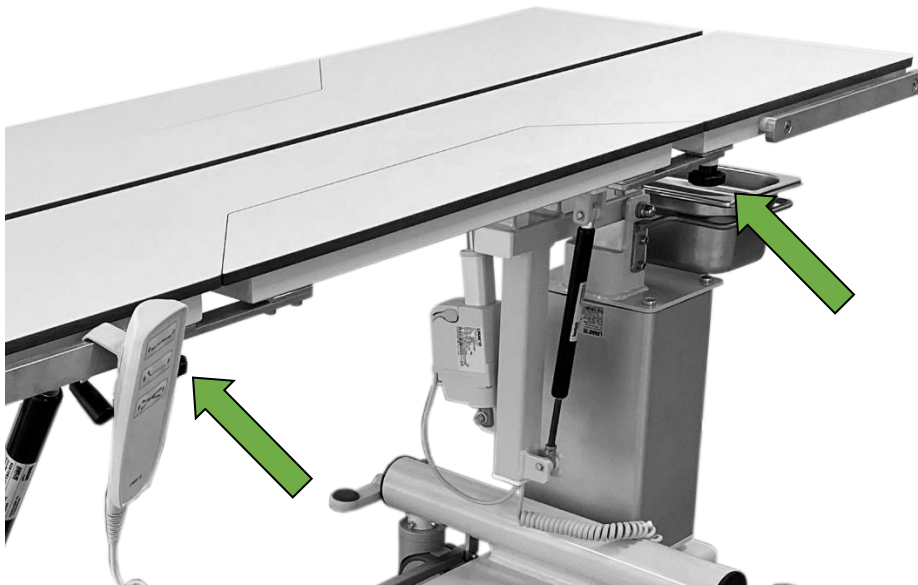

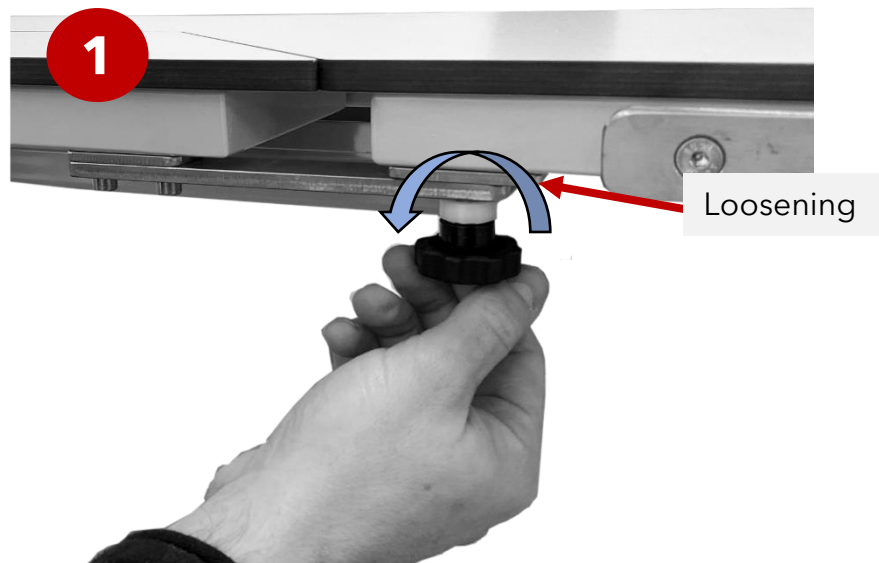

After loosening both locking screws (left and right!), the corresponding laparoscopy cut-out can be pulled out of the table top in parallel to the plate surface for removal. It is advisable to use both hands to detach the cut-out from the device parallel to the two fixation points (near the locking screws).

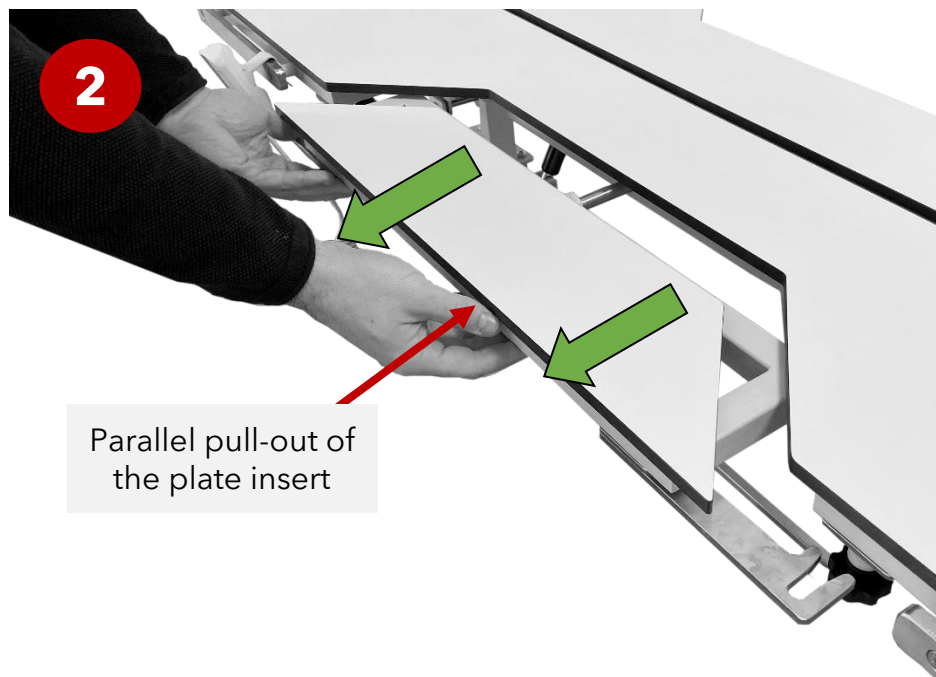

Finally, after removing the cut-out, the two locking screws can be re-tightened to stabilize them again and prevent any accidental detachment or loss.

The removal of the corresponding laparoscopy cut-out is now finished and the table ready for further use.

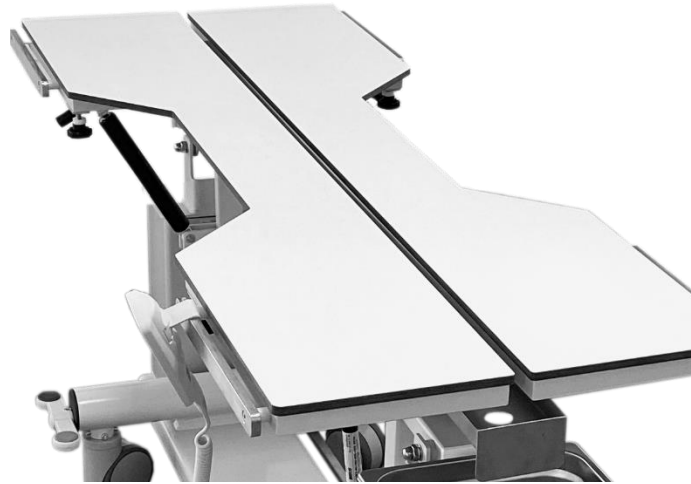

To reconnect or install a previously removed laparoscopy cut-out to the table top, the two locking screws must first be loosened (as shown above) in order to prepare the upper frame of the table for mounting the cut-out accordingly.

As already mentioned, it is important to ensure that the correct laparoscopy cut-out is inserted into the designated table top half (labelled with stickers), as the two cut-outs are different and otherwise a stable and/or aligned connection with the table cannot be ensured as well as possible damage may be caused as a result.

Subsequently, the respective cut-out can be completely inserted parallel to the table top with the round stainless steel bolt being placed into the slot provided for this purpose at the center of the table top upper frame.

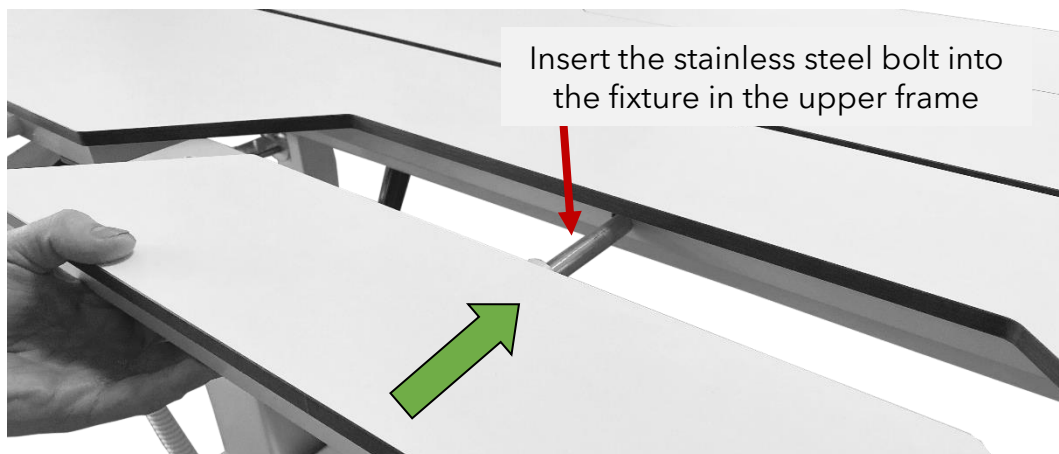

When doing so, always ensure that the two side stainless steel brackets of the laparoscopy cut-out are also fully inserted in a correct manner as well as parallel to the respective fixation points at the locking screws (as shown in the figure below).

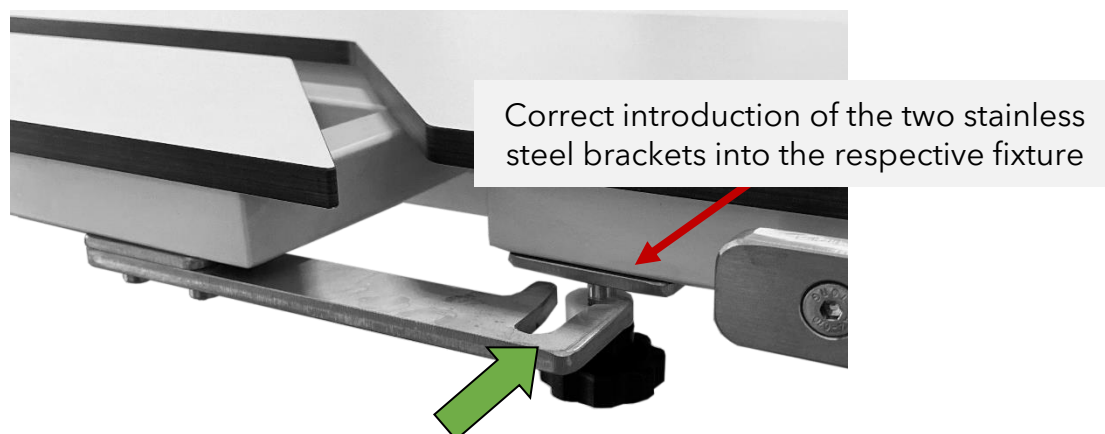

As soon as the respective laparoscopy cut-out has been completely reinserted (both the central stainless steel bolt and the two side stainless steel brackets) into the respective fixtures provided on the upper frame of the corresponding table top section in parallel, the two side locking screws (as already shown above) must be tightened or fixed hand-tight again for the subsequent securing of the cut-out to ensure that it is appropriately stabilized and firmly connected to the table top. Afterwards, the table is ready for further use again.

Usage of tie-down cleat (accessory part)

In case any tie-down cleats or similar accessories have been included in the scope of delivery, these may normally be attached to the rails that are connected with the side of the product.

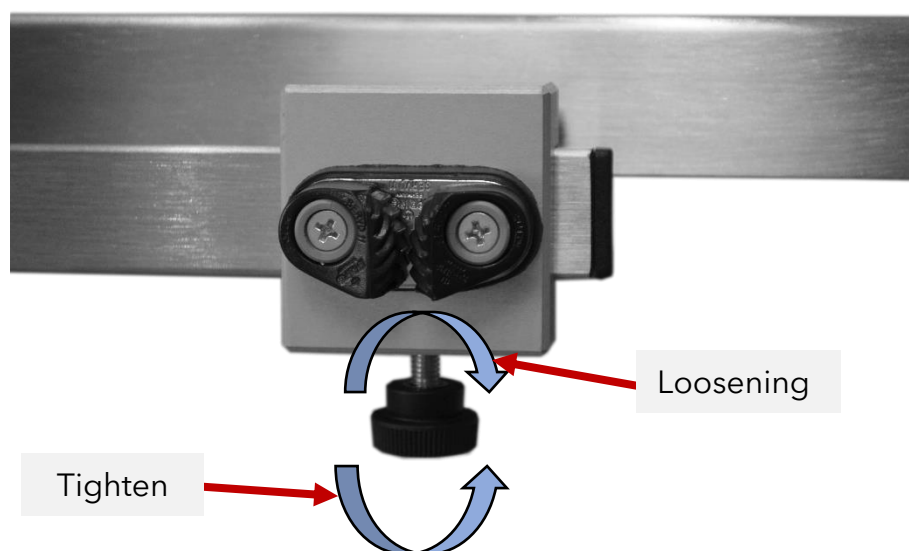

Prior to use, the accessory has to be loosened at the respective locking screw and threaded laterally onto the siderail. Once the desired position of the tie-down cleat on the rail has been attained, it must be tightened at the locking screw to stabilize it in place.

If a change in the positioning of the accessory is necessary, loosen the respective locking screw, adjust the position on the side rail accordingly and secure the tie-down cleat once again by tightening the locking screw.

Usage of drain gutter (accessory for V-Top version)

The " drain gutter" accessory supplied with the V-Top version of the TREND table is used to collect and retain liquids and residues that may arise during treatment and surgical procedures.

The drain gutter can be inserted into the fixture provided for this purpose on the front side of the product as shown in the illustration below.

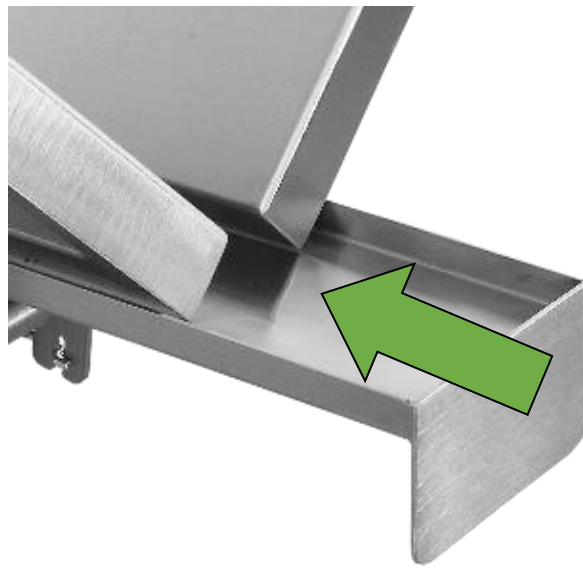

Removing the drain gutter from the fixture can also be done manually by pulling it out and lifting it from the respective fixture on the front side of the product.

Usage of drip tray (Version with X-Top)

In case you have opted for an OP-System with X-Top and removable laparoscopy cut-outs, a detachable stainless steel drip tray is included in the standard scope of delivery in addition to the drain gutter (see description in previous chapter). The hole in the drain gutter is intended to automatically divert excess liquids into this drip tray.

As shown in the following figure, the drip tray concerned is located at the front side underneath the table top and attached to the table using a round stainless steel holder specifically installed for this purpose.

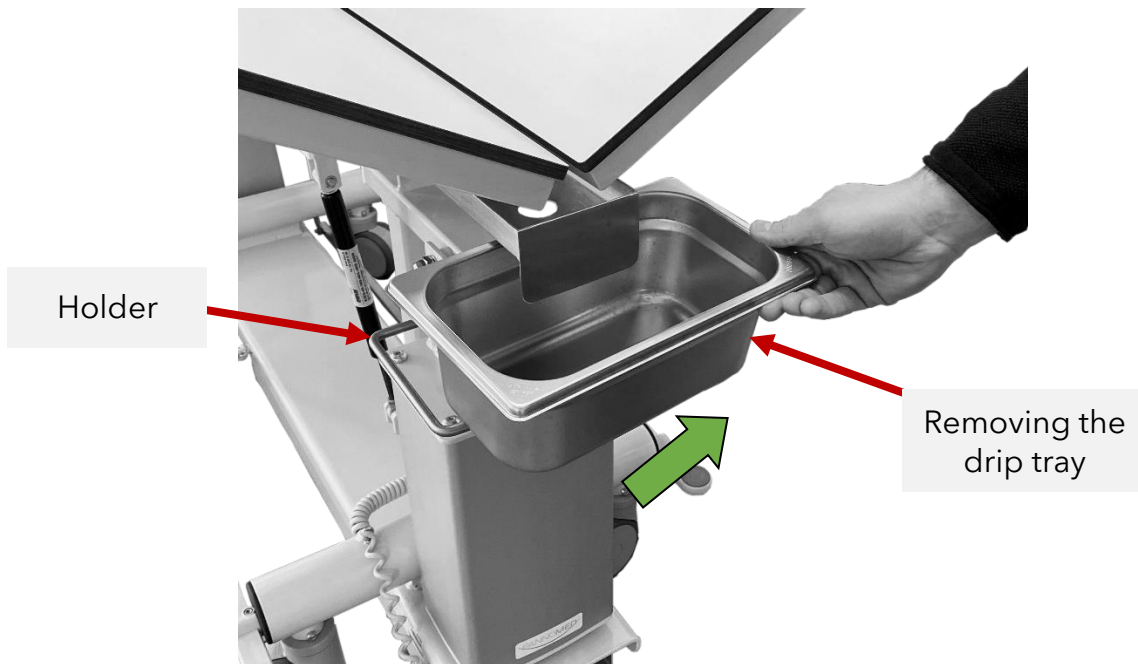

The drip tray can be easily detached from the corresponding holder - e.g. for emptying and cleaning - (by first pulling it upwards and then slightly to the side to prevent it from colliding with other parts of the table) or reinserted (in reverse order) as well as reconnected to the table.

Power supply (electric version with power cord)

The product is equipped with a power plug in the electric version. This provides voltage to all electronic components that are installed in the table, especially the electric actuators.

A suitable power cord including a power plug is included in the scope of delivery. To avoid injuries and other malfunctions, only connect the power cord to a power circuit when the table is actually in operation.

Charging the table (battery-powered version)

In case you have chosen a battery-powered version of the present product, a sophisticated battery system has already been pre-installed within your table. This provides power to all electrical consumers that are built into the table, particularly the electric actuators.

Thereby, the battery is located on the front side of the tables chassis near the bottom and can be easily disconnected from the table by pressing the tab on the black edge of the battery.

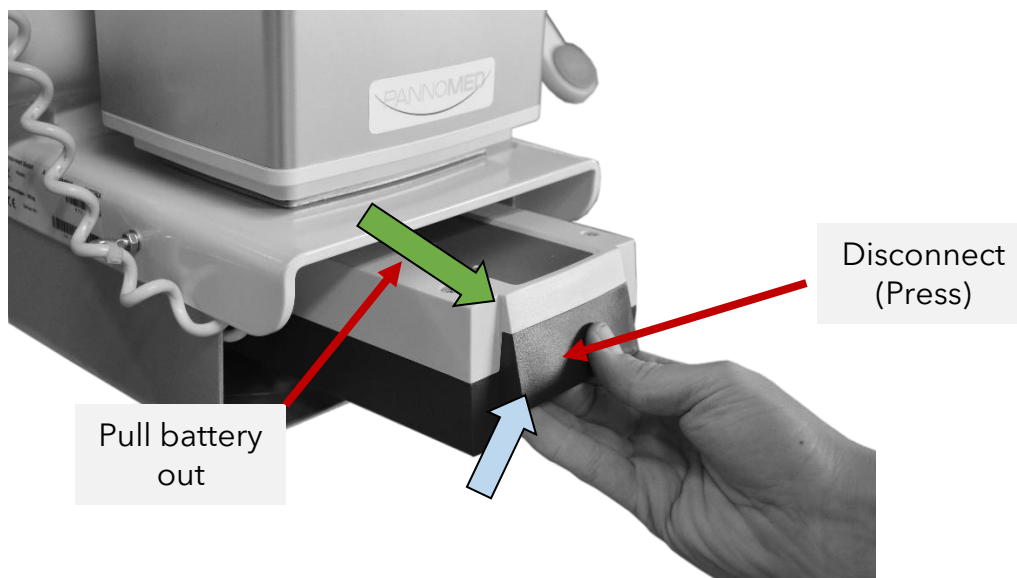

Reinserting the battery is done by sliding the battery into the housing until an audible click is heard and the battery is thus securely locked in place and connected to the product.

In order to achieve a long battery lifespan, it is recommended to fully charge the battery after operation every day (for example, overnight). This is the most effective way of avoiding a deep discharge of up to 100% over the course of the application period. Otherwise, the battery lifespan would be considerably shortened, as a higher depth of discharge of the battery results in extended wear and tear of the battery.

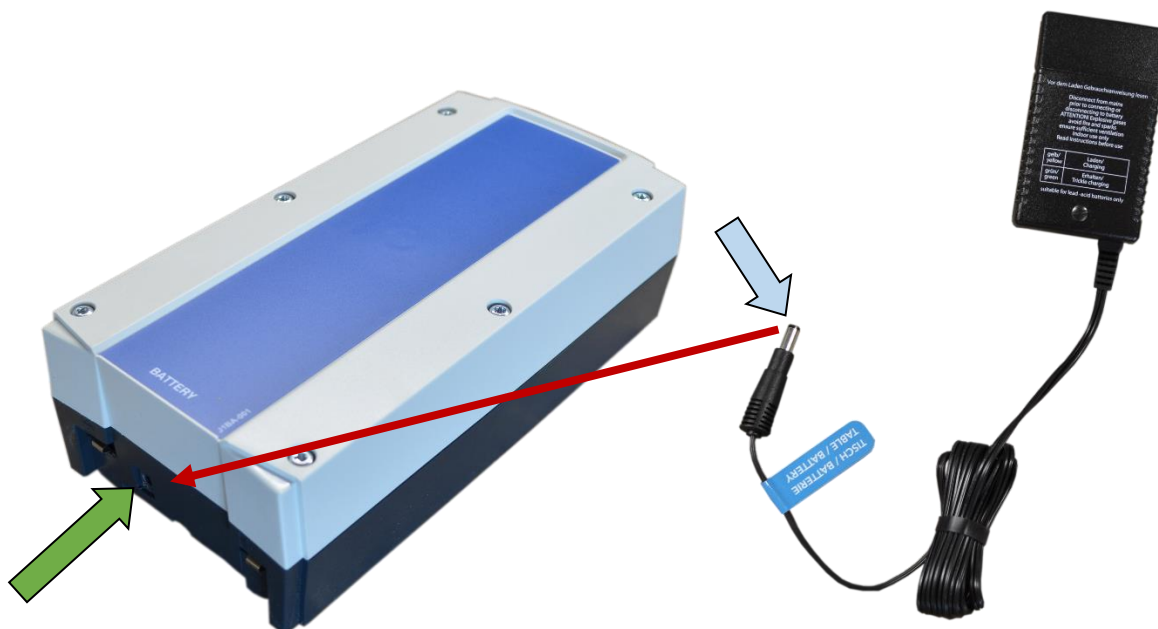

The supplied power charger has to be connected to the external power socket on the one hand and to the socket on the battery's front with the connector on the other hand during the charging process, as well as disconnected again after the charging process is finished.

Having a second spare battery plugged into the charger meanwhile proves to be very useful in this case. This battery is fully charged when the LED light on the charger goes out. Please note that the number of possible strokes with one battery charge depends on the respective load (therefore, more load means fewer strokes).

Error handling & Troubleshooting

This section describes how to proceed if a problem or error occurs with your *panno-med* product. Please follow the steps and recommended actions in detail.

In case none of the described solutions and recommendations achieve the desired result or eliminate the existing problem, as well as in case of any further queries, please contact the authorized distributor from whom you purchased your *panno-med* product. For exact identification of your product, be sure to cite the serial number (starting with 14-...) of the product in question, which is located on the type plate.

Potential error

At least one electric actuator does not work

Recommended course of action

- Check if the battery (if applicable) is inserted as well as whether the electrical power supply to the product is provided.
- Ensure that the battery is fully charged or that the socket through which you want to supply electrical power to the product is actually connected to electricity.
- Verify that all cables and electronic components, operating elements, etc. are correctly connected to the respective control unit and that no cable has been unplugged.
- Inspect the electronic components as well as cables for possible cracks, crushing or other damage that could prevent the electrical actuators from functioning correctly.
- Reset the control unit to factory settings according to the procedure described below.

Reset the control unit

1. First of all, please ensure that the table is supplied with electrical power or that its battery is correctly inserted and fully charged.
2. Simultaneously press the two middle buttons marked right on the control unit and hold them down until a long, clear beep sound is heard coming from the control unit.
3. Once the beep tone is heard, the control unit has been reset correctly.
4. Occasionally, before resetting the control unit, it may also be necessary to bring all electrical actuators to their lowest position in order to ensure optimal auto-calibration.

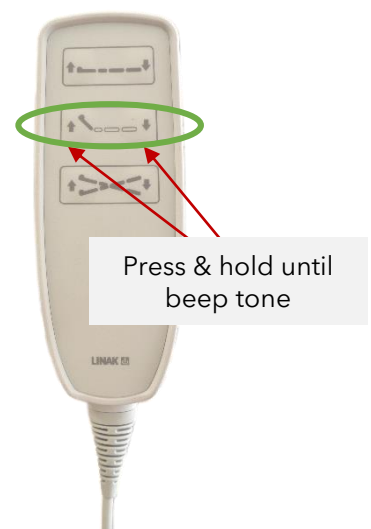

Cleaning and disinfection instructions

Regular and proper cleaning ensures an extensive lifespan of your product.

Failure to comply with the cleaning measures as recommended may result in serious infection hazards!

The present product is equipped with either a stainless steel or synthetic top as well as a powder-coated steel chassis or a frame made of top-quality, electropolished stainless steel.

In fact, the frame is extremely resistant to corrosion and rust. For the product to achieve the longest possible lifespan, it should be routinely and thoroughly cleaned.

Cleaning may be performed using wet cloths with mild cleaning agents and disinfectants. Use only standardized and common cleaning agents and disinfectants. Prescribed dosages and dilutions must be observed at all times. The table surface should be wiped regularly using just wet cloths together with conventional cleaning agents.

Strictly avoid:

- corrosion-promoting or aggressive cleaning products
- detergents containing harmful substances
- abrasive cleanings
- cleaning products affecting the epoxy coating

Make sure to always read the product information and observe the instructions for the respective cleaning products and disinfectants. The manufacturer cannot be held liable for damage, injuries and impairments which are the result of improper use of cleaning products or disinfectants.

Attention: The product is NOT suitable for automatic washes and bed sterilizers. The use of a high-pressure cleaner is also prohibited.

Always disinfect the product before a new patient is placed on the table top. Only qualified and trained personnel who are instructed in the effects and usage of disinfectants may carry out the disinfection. Appropriate protective clothing and gloves must always be worn when cleaning and disinfecting.

It is strongly discouraged to apply an additional protective coating in the form of varnish or paint.

Cleaning synthetic top

A "mild" disinfectant (e.g. kitchen detergent) is sufficient for cleaning the synthetic top. The entire surface of the plate should be rinsed frequently with clear water and wiped dry. Residues such as blood or urine should be able to be removed with soap and water. In the case of stubborn residues, it may be necessary to use a suitable brush in conjunction with a special cleaner, such as the PANNOMED "Synthetic Top Cleaner & Care".

To remove calcium deposits or such limestones, one should preferably use vinegar and then rinse the surface with clean water. Wipe dry with a soft cloth.

Regular cleaning with water and "mild" detergents as well as subsequent dry rubbing with soft cloths has proven to be the ideal care for synthetic tops.

Never use steel wool or steel brushes. If necessary, use nylon or other plastic brushes only.

A weekly cleaning with a special synthetic cleaner is recommended. Contact your local distributor for this product.

Cleaning stainless steel top (version with V-Top)

For cleaning the stainless steel top, a "mild" disinfectant (e.g. kitchen detergent) is sufficient. The entire top surface of the plate should be rinsed frequently with clean water and wiped dry. Residues such as blood or urine should be removable with soap and water. In the case of stubborn residues, it may be necessary to use a suitable brush in conjunction with a special cleaner, such as the PANNOMED "Stainless Steel Cleaner & Care".

Never use steel wool or steel brushes, as otherwise micro particles could penetrate the surface of the stainless steel top and cause corrosion. If necessary, only use nylon or other plastic brushes.

To remove calcium deposits or such limestones, preferably use vinegar and subsequently rinse the surface with clean water. Afterwards, the surface of the plate should be wiped dry with a soft cloth.

Avoid extended contact of halogen-containing substances (chlorine, bromine, iodine) and thiocyanate with the stainless steel surface. Prolonged contact or drying of salty solutions may also cause discoloration or corrosion.

The use of various PVC plastic mats as underlays is also not recommended. Heat exposure in some operating lights can cause chlorides to escape, which in turn may come into contact with the stainless steel plate and lead to discoloration or corrosion of the latter.

Regular cleaning with water and "mild" detergents as well as subsequent rubbing dry with soft cloths has proven to be the ideal way to care for stainless steel plates. In this context, one should bear in mind that there is no such thing as a completely corrosion-free stainless steel plate, in whatever alloy form, so far.

The use of additional protective coating in the form of varnish or paint is also strongly discouraged. Engravings of names or other carved information on the stainless steel plate will immediately lead to surface corrosion.

New stainless steel table tops usually have a flawless surface. Only on a brand new table top you will be able to notice a scratch immediately. However, it should be mentioned at this point that already after a very short time there will be so many, smaller scratches that the overall appearance will be accepted as such.

Supplementary cleaning recommendations for powder-coated surfaces

To ensure a long lifespan for your product, the use of proper cleaning products for powder-coated materials is strongly recommended. Follow the instructions provided by the powder coating manufacturer as indicated below.



Cleaning Recommendations

FOR POWDER COATED SURFACES

A thorough cleaning of surfaces is required

- to conserve the decorative appearance of the surface and
- for the exterior application to reduce corrosion strain

The following minimum requirements apply:

Cleaning-compatible component design

Cleaning-compatible component design has a critical influence on the cleanability of components during their service life. The constructional design and geometry of a component largely determine its likely degree of soiling, as well as the future soiling behaviour caused by e.g. upright surfaces, joins and dirt run-off routes that channel concentrated flows of soiling across visually exposed surfaces. Failings in the constructional design can often not be compensated by a powder-coated surface, not even in conjunction with the right cleaning techniques.

Regular cleaning

If the component is not cleaned during its service life, or is cleaned only irregularly or improperly, this accelerates the soiling process. Depending on the influencing conditions, this in turn may lead to irreparable surface defects (e.g. corrosion, chalking, etc.) and even to a complete loss of decorative appearance. The component may thus only be expected to retain its value and functionality if cleaned regularly and often over the course of its service life, as necessitated by the soiling (i.e. depending on the environmental conditions and the location).

Cleaning of powder coated surfaces

- as the case may be, only clean water, with slight additives of neutral washing agents (pH 7), is to be used with the aid of soft, non-abrasive cloths, rags or industrial cotton. Strong rubbing is not to be undertaken.
- the removal of greasy, oily or sooty substances can take place with the use of isopropyl alcohol (IPA) or white spirit free of aromatic compounds. Residues of adhesives, silicone cartouche or adhesive tapes, etc., can also be removed in this way.
- use no solvents or similar, containing ester, ketones, polyhydric alcohol, aromatics, ethylene glycol or halogenated hydrocarbon.
- joint sealants and other aids such as glazing aids, lubricant agents, drilling and cutting lubricants etc., which come into

contact with coated surfaces must be pH-neutral and free of paint damaging substances. They must first be subjected to a suitability test.

- due to the danger of changes in a color tone or effect, a test for suitability is to be undertaken for metallic coatings.
- use no scratching, abrasive agents.
- use no strong acids or alkaline detergents and introfiers.
- use no detergents of unknown compositions.
- detergents must not be used at temperatures higher than a maximum of 25°C.
- the surface temperature must not exceed 25°C during cleaning.
- the maximum exposure period of these detergents must not exceed one hour: when necessary, the entire cleaning process can be repeated after at least 24 hours.
- rinsing with clean cold water is to take place immediately after every cleaning process.
- Fine-textured effects: Use fibre-free cloths. Moderate mechanical support may be given to the cleaning operation using a soft, non-surface-damaging brush.
- It is a well-known fact that with their ingredients increasing the sun protection factor, cosmetic products, including sunscreens such as suntan lotions, oils and creams in particular, adversely affect powder coatings. Such ingredients diffuse into the coated finish and then lead to impairment of the powder coating finish. Even short-term exposure to their aggressive effect on the finish, sunscreen agents may result in more or less severe spotting on the powder coating finish. Therefore, regular cleaning of the paint layer immediately after exposure to cosmetic product is recommended to protect the paint finish.

Certified facade cleaning

Proper maintenance and regular servicing of the coated surfaces are both prerequisites for the claims of any guarantee and require regular cleaning at least once each year. For severe environmental pollution, for example in regions with increased salt contamination and/or chemical exhausts, meaning in a direct area of influence or within the vicinity of an industrial or chemical enterprise, or in the immediate vicinity of a sea coast or within a defined chemical/radioactive precipitation zone, the building must be cleaned more often. In this way possible damage can be made subject to timely recognition and remedied on time by suitable measures. If a coated component is soiled during transport, through storage or assembly, the cleaning of this component must take place immediately with clear, cold or lukewarm water. Neutral or a weak alkaline detergent can be used against severe soiling.

Technical Information Sheet



The prerequisite for proper care of the coated construction is that the construction is regularly cleaned according to the guidelines of the Registered Quality Association for the Cleaning of Metal Facade Elements, and is carried out by a member of the above-name association with detergents and cleaning aids in accord with RAL-GZ 632-1996 and certified by the same association for the certified cleaning of facades with coated surfaces - before every initial cleaning and before every change to another detergent and cleaning-aid during ongoing cleaning intervals, these are to be additionally tested for their suitability on a test area facing south on an unexposed point of at least 2 m².

Further instructions for maintenance and cleaning are available from, among others, the:

- Aluminium-Zentrale Beratungs- und Informationsdienst in D-40003 Düsseldorf (Aluminium Center, Advisory and Information Service)
- Gütegemeinschaft für die Reinigung von Metallfassaden e.V. (GRM) in D-90402 Nürnberg (Registered Quality Association for the Cleaning of Metal Facade Elements)
- American Architectural Manufacturer's Association (AAMA) U.S.A., (AAMA 610-1979 Cleaning Procedures)

Disclaimer

Our verbal and written recommendations for the use of our products are based upon experience and in accordance with present technological standards. These are given in order to support the buyer or user. They are non-committal and do not create any additional commitments to the purchase agreement. They do not release the buyer from verifying the suitability of our products for the intended application. We warrant that our products are free of flaws and defects to the extent as stipulated in our Terms of Delivery and Payment.

As a part of our product information program each of our Product Data Sheets are periodically updated, so that the latest version shall prevail. Therefore, please visit the download area of www.tiger-coatings.com to make sure you have the most current version of this Product Data Sheet. The information in our Product Data Sheets is subject to change without notification.

This Product Data Sheet substitutes any and all previous Product Data Sheets and notes for customers published on this subject matter and is only intended to give a general product overview. Please request specific information for products outside of our standard product list (latest version). The Technical Information Sheets and the Terms of Delivery and Payment each in their latest version, available as a download at www.tiger-coatings.com, form an integral part of this Product Data Sheet.

certified according to
EN ISO 9001 / 14001



TIGER Coatings GmbH & Co. KG
Negrellistrasse 36 | 4600 Wels | Austria
T +43 / (0)7242 / 400-0
F +43 / (0)7242 / 650 08
E powdercoatings@tiger-coatings.com
W www.tiger-coatings.com

Maintenance & Repair

Repair work may only be carried out by personnel who have been authorized by the manufacturer.

In the event of a malfunction or deficiency, the device can only be repaired by a qualified technician approved by panno-med. In such an event, please mark clearly that the device is OUT OF SERVICE. Repairs performed by unqualified personnel may result in serious damage or injury.

Regular maintenance check

It is recommended to perform a regular, annual inspection of the device by trained personnel that are authorized by the manufacturer.

This inspection must include at least the following aspects:

1. Comprehensive visual and functional test
 - a. Visual inspection
 - All welding seams for cracks
 - Surface damages
 - Damages to the table top
 - All cables (bruises, abrasions, exposed wiring)
 - Visual inspection for leak-tightness of hydraulics
 - Hinges and swivels
 - Safety locks (circlip, screws, star lock) on all swivel joints, hinges, and motor suspensions
 - Visual inspection for completeness and damage of the plastic bushings in the actuator mountings
 - Visual inspection of all gas springs for leak-tightness
 - b. Functional test
 - Height adjustment
 - Tilt adjustment
 - Operation of castors
 - Push handles
 - Moveable components
 - Chassis and suspension
2. Function of the operational elements and check of the table control for damage
3. Battery and control unit are examined for charging activity
4. All bolt & screw connections inspected for tightness
5. Electrical test
6. Safety check

Spare parts and accessories

Use only spare parts or accessories which have been approved by *panno-med*.

Do not make any modifications to the product without prior permission from the manufacturer: Any modification may result in unpredictable and unanticipated malfunctions and thus in damage or injury to the patient.

The manufacturer is not liable for any damage or injury caused by modifications to the product and/or the use of non-original spare parts or accessories without the prior knowledge and written authorization of *panno-med*.

Accessories & Supplies

Product description	Item code
Holder with eyelets (500 mm width)	602.519
Tie-down cleat	602.601
Infusion pole	602.602
Adjustable side supporters	602.604
Narcotic bow	602.605
Leg support with fixation clamp	602.606
Tilting stainless steel dish with grad	602.607
OP-rail extension (200 mm/pair)	602.610
Instrument tray (300x200 mm)	602.611
Arm rest for ophthalmology	602.614
Top extension (500x300 mm)	602.615
Top extension (300x300 mm)	602.616
Elbow pad	602.630
Traction device	602.631
Belt with tension clamps	602.632
Limb holder	602.633
Insert for OP-System V2	602.635-OPSN*
Ultrasound table (with triangle cutout)	602.640.1
Lateral positioners (with set of 3 different types of cushions)	602.641
Lateral positioners (with toothed joint)	602.646
X-ray translucent top extension (500x300 mm; 90° tilting)	612.232

* available only for version with sliding top

Safety responsibility

Responsibility for ensuring that the product guarantees the safety of the patient during its entire lifespan resides with the person instructed in the use of the product. Furthermore, we recommend that all mechanical functions are checked before each operation. If you suspect that the device is damaged or not functioning correctly, discontinue its use immediately. In case of uncertainty as well as insufficient user information, contact your authorized reseller or the manufacturer.

SAFETY INSTRUCTIONS

- 1) Prior to operating the control elements for height or electrical adjustment, ensure that the movement of the product is not impeded by objects or other obstacles.
- 2) In particular, please verify that no persons, animals or other objects are located underneath the range of motion of the device before starting its operation.
- 3) The user is responsible for checking that the product is undamaged before operating it. If visually recognizable damage is apparent (for example, chipped corners, damaged frames), the product is not allowed to be operated.
- 4) The function of the castors (directional and complete locking) must be examined prior to operation of the device.
- 5) The product may only be operated by properly instructed personnel.
- 6) Any adjustment of the product may not be performed by the patient.
- 7) Users are responsible for ensuring that the weight is evenly distributed across the product. Punctual loading must be avoided by all means.
- 8) The usage of other accessories, which are not explicitly approved by panno-med for the intended purpose, is prohibited.
- 9) During all movements, take care not to injure the patient, especially when lifting and lowering the table top.
- 10) When moving the product, be cautious not to run over someone's feet or into an obstacle.
- 11) Lock the brakes whenever the product is not intended to be moved. This secures the product against unintentional movement, especially when a patient has been placed on the device.
- 12) Before moving the product, ensure that no animals, persons, operating personnel or any objects other than the patient are within the range of movement of the device.
- 13) Verify that the user or a third person is not sitting or lying on the product.
- 14) When moving the device in any direction, ensure that there are no loose objects on the table top.
- 15) Do not allow children in the vicinity of the product without supervision, there is a serious risk of injury.

Collisions of the table top with other objects and/or sudden application of force must be avoided by all means. Irreparable damage to the product could result.

Special warnings

Trapping or pinching is possible at various spots on the product.

Particular attention must be paid that:

- Parts of the patient's body are not located within this range
- Parts of the user's body are not located within this range or
- Body parts of third persons are not located within this range.

DURING CLEANING AND MAINTENANCE WORK, DISCONNECT THE PRODUCT FROM THE POWER SOURCE TO AVOID THE RISK OF ACCIDENTAL ENTRAPMENT.

Local distribution of maximum load

Despite the exceptionally stable and robust design of the table, which enables a particularly high maximum load for this product (as specified in the Technical Specifications), it is essential to ensure that loads are distributed evenly over the table surface at all times. High point loads must be strictly avoided.



Product warranty

panno-med provides a warranty for the proper functioning of the product from the date of sale up to 24 months. The buyer must notify the manufacturer of any damage under warranty immediately. The warranty is valid only upon submission of the original invoice.

Exclusion of warranty:

- The operator has not complied with the Instructions Manual supplied with the product.
- An unauthorized person has interfered in the product.
- The operator has improperly and negligently handled the product.
- Non-original parts were installed in the product.
- The damage occurred during transportation after the product was handed over to the buyer.

For all further questions regarding the product, please feel free to contact our authorized distributors.

Date of publication: 7th December 2023

