

QUICK START GUIDE

**Tono-Vera™ Vet**  
Tonometer

## Getting to Know Tono-Vera™ Vet Tonometer

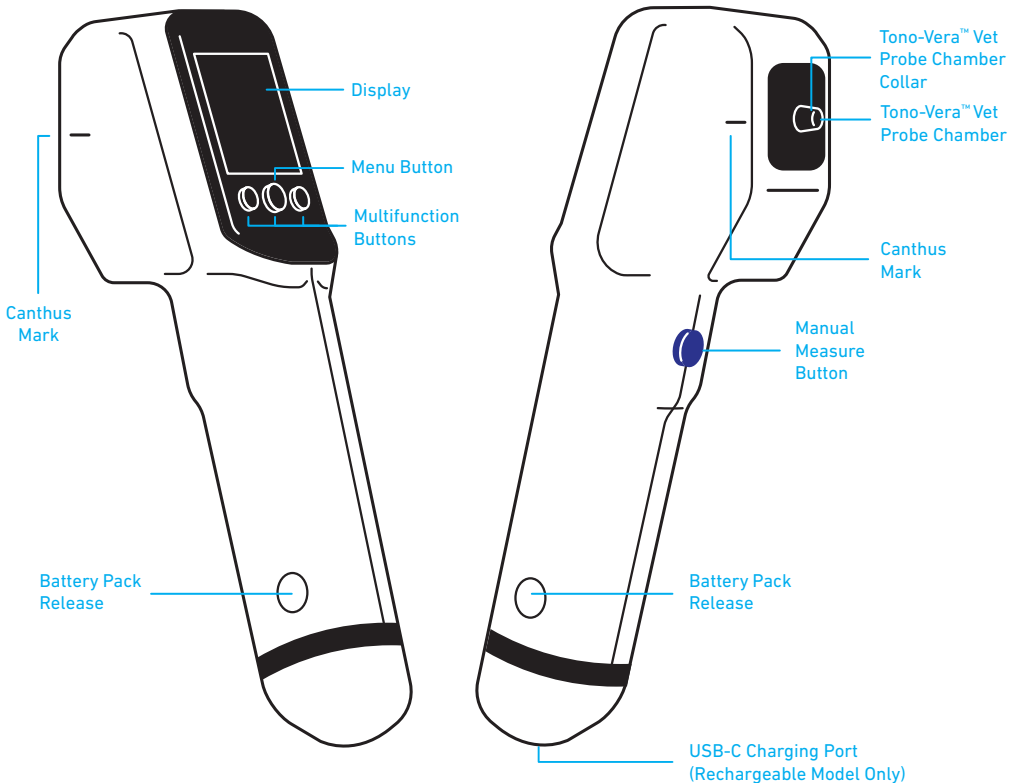

# Setting Up Tono-Vera Vet Tonometer

## Rechargeable Battery Model

Slide the Tono-Vera™ Vet Li-Ion Rechargeable Battery Pack into the device until it clicks into place.



Plug in the Tono-Vera Vet Charging Base and place Tono-Vera Vet on the base to charge.

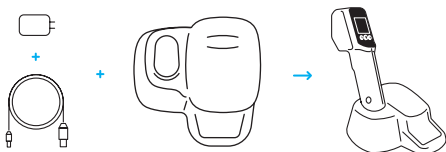

## AA Battery Model

Insert the batteries into the Tono-Vera Vet AA Battery Pack and slide it into the device until it clicks into place.

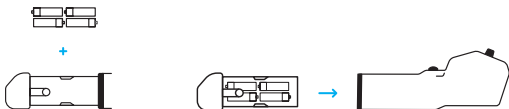

## Power On/Off

Press any button to turn Tono-Vera Vet on.

To turn off, press and hold the center Multifunction Button for three seconds.

## Ocu-Dot™ Probe Storage

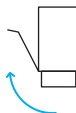

Open the Ocu-Dot™ Tonometer Probes - 100 Count box and fold the flap back along the side.

Load the Ocu-Dot Probe box with the tray into the rear of the base.

Push the Ocu-Dot Probe tray fully into the base.

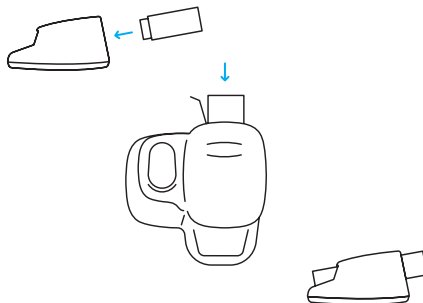

## 1 Loading the Probe



When powering on Tono-Vera Vet Tonometer, the screen will prompt to load an Ocu-Dot Probe if one isn't already loaded.



Remove Ocu-Dot Probe Tube Cap.

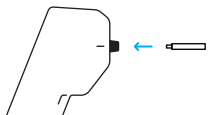

Insert Ocu-Dot Probe Tube into Probe Chamber.

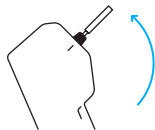

Rotate the unit so the Ocu-Dot Probe slides into the Probe Chamber.

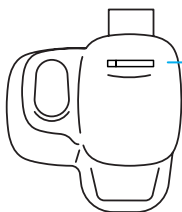

Store Ocu-Dot Probe Tube in Tono-Vera Vet Base recess.

## 2 Main Screen

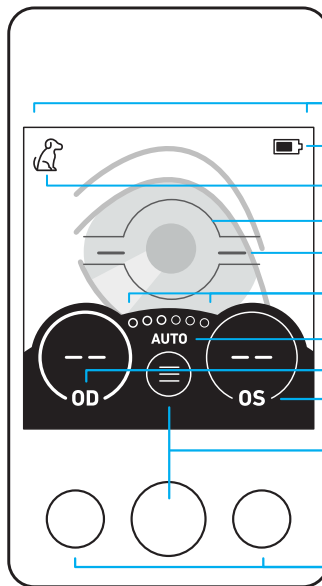

ActiView™ Positioning System Area

Battery Indicator

Species

Alignment Target

Probe Angle Indicator

Number of Measurements

Measure Mode

OD (Right Eye)

OS (Left Eye)

Menu

Select OD/OS Buttons

### 3 Positioning

Tono-Vera Vet Tonometer will automatically measure when properly aligned. It is suggested to practice measuring with the included Tono-Vera Vet Training Aid.

It is recommended to hold the unit so the Ocu-Dot Probe and Canthus Marks are perpendicular to the eye. The unit can measure when the probe angle is  $\pm 15^\circ$  from level. The probe tip should be approximately 4-8 mm from the eye.

#### Correct Probe Angle

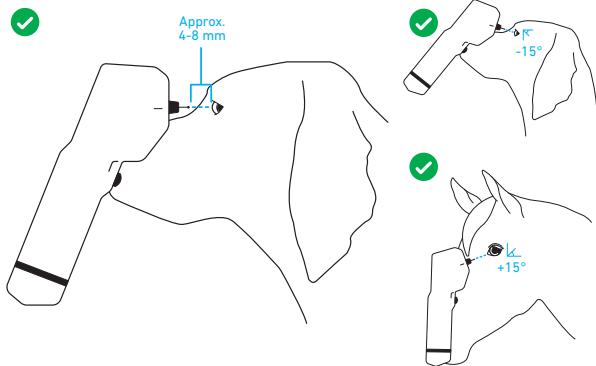

#### Incorrect Probe Angle

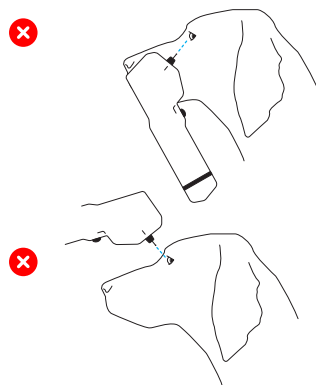

#### Device Orientation

Tono-Vera Vet can be rotated a full  $360^\circ$  around the axis of the Ocu-Dot Probe, as long as the probe is kept parallel to the ground, within the  $\pm 15^\circ$  probe angle range.



## 4 Aligning

Correct distance, centration, and probe angle must be achieved simultaneously. The on-screen ActiView™ Positioning System guides the user to proper alignment. When the proper distance, centration, and probe angle are achieved, measurements will be taken automatically.

### Distance & Centration (Approx. 4-8 mm)

A ring will appear when an eye is detected. The ring size is determined by distance, the ring color is determined by both distance and centering. A beep will sound and a stop sign will appear when the unit is too close to the eye.

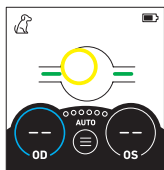

Small Yellow Ring:  
Too Far and/or Off-Center

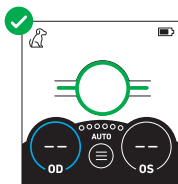

Green Ring:  
Proper Distance  
and Centration

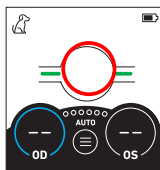

Large Red Ring:  
Getting Too Close  
Beep Will Sound

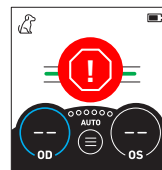

Large Red Stop Sign:  
Too Close  
Beep Will Sound

### Probe Angle

The Probe Angle Indicators aid in obtaining the proper probe angle. Tono-Vera Vet is able to measure within a probe angle range of  $\pm 15^\circ$ . The color and position of the Probe Angle Indicators represent whether the unit is in or out of the probe angle tolerance. The device will not measure if the device is outside of the  $\pm 15^\circ$  probe angle range.

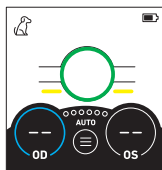

Yellow Probe Angle Indicators:  
Probe Angle Too High

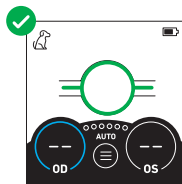

Green Probe Angle Indicators:  
Proper Probe Angle Alignment

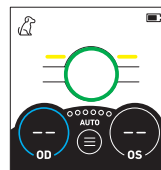

Yellow Probe Angle Indicators:  
Probe Angle Too Low

## 5 Measuring

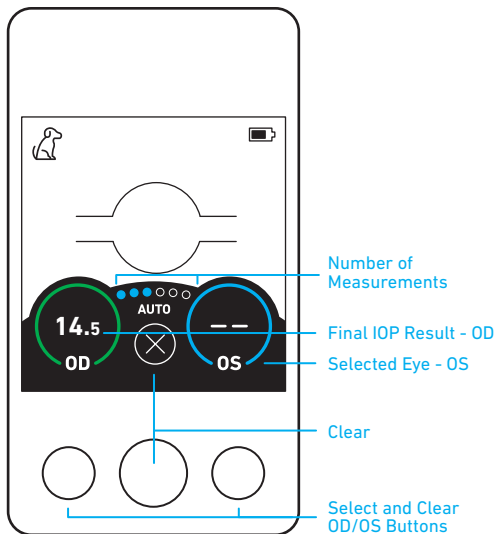

A blue circle indicates the active eye being measured.

The dots indicating the Number of Measurements will fill in as each measurement is taken.

After completing measurements for an eye, the Final IOP Result will be briefly displayed in the center of the screen. The result will remain inside the OD or OS ring until cleared. The color of the ring around the Final IOP Result indicates the reliability of the measurement.

## 6 Understanding Results

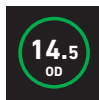

**High-Confidence Result**  
Final IOP Result appears in a green ring.



**Low-Confidence Result**  
Final IOP Result appears in a yellow ring.



**Retake Measurement**  
No IOP Result will appear in an orange ring.

## Action Screens

When taking measurements, the following screens may appear, prompting action. See Instructions for Use for more detailed information.



Too Far  
from Eye



Load  
Probe



Clean Probe  
Chamber

## Clearing

To clear all data, press the Clear Button (X).

To clear data for one eye only, press the corresponding Select and Clear OD/OS Button.

## Menu Screen

Access settings, information, and more.

Use the Navigation Buttons to cycle through screens.  
Press Select to change the current selection.

The highlighted option displayed is the active selection.

To exit Menu Screen, navigate to Exit and press Select,  
or press the Manual Measure Button at any time.

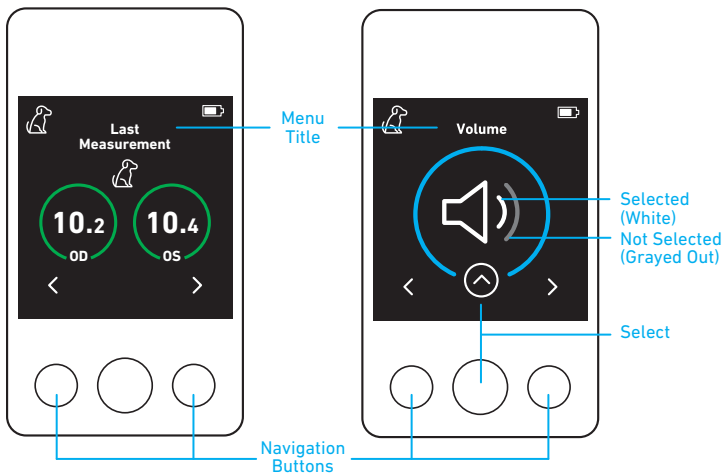

For additional information and translations refer to the Instructions for Use on the included USB drive, or scan:



**Manufactured by:**  
Reichert, Inc.  
3362 Walden Avenue, Suite 100  
Depew, NY 14043 USA  
Toll Free: 888-849-8955  
Phone: +1-716-686-4500  
reichert.information@ametek.com  
reichert.com

Authorized European Representative  
Emergo Europe  
Prinsessegracht 20  
2514 AP The Hague, The Netherlands

Authorized European Service Center  
AMETEK GmbH  
Business Unit Reichert  
info.reichert-de@ametek.com  
Phone: +49 (89) 315 89 110

Reichert and Reichert Technologies are registered trademarks of Reichert, Inc.

Tono-Vera, Ocu-Dot, and ActiView are trademarks of Reichert, Inc.

AMETEK is a registered trademark of AMETEK, Inc.

All other trademarks are properties of their respective owners.

2021-01-07

16308-105 Rev. B

